

JULY -SEPTEMBER 2020 | ISSUE 4

THE QUARTERLY **OUTLOOK**

OFFICIAL NEWSLETTER OF THE KENYA SCHOOL OF REVENUE ADMINISTRATION (KESRA)

‘New Normal’ in the learning institution

“ In order to create an engaging learning experience, the role of instructor is optional, but the role of learner is essential.”
- Bernard Bull



Accessing KESRA eCampus

STEP 1 : Access KESRA eCampus portal through this link : <http://ecampus.kra.go.ke/ecampus/>



STEP 2 : Login with your credentials on 'Username' and 'Password'



STEP 3 : Click on 'My Dashboard'

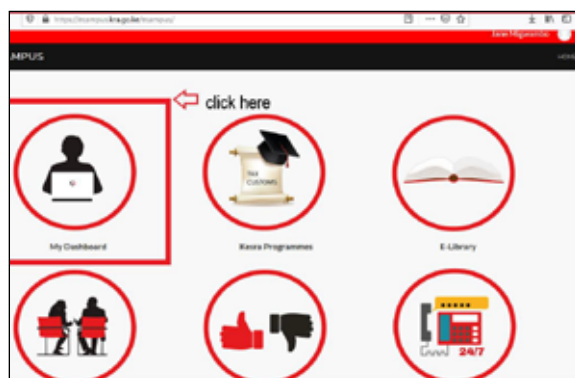

STEP 4 : You will be presented with a summary of the courses you are enrolled to in the system

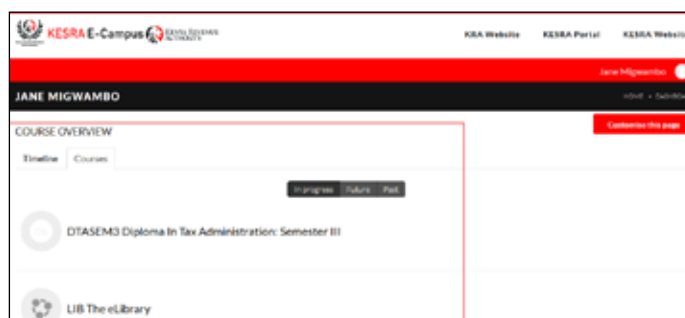

STEP 5 : Click on the course and note that course units will be indicated in numbers

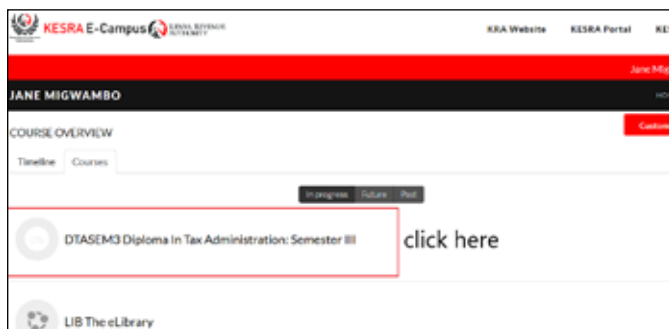

STEP 6 : Click on the number you desire to access the course unit.

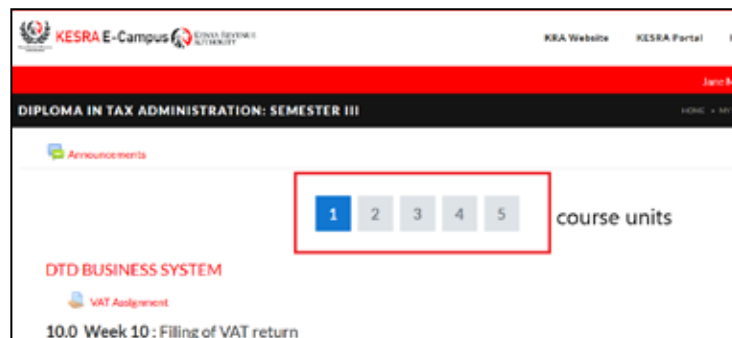

Accessing KESRA eCampus

STEP 7 : Click on the provided resources (videos, assignments, discussion forums) to access them.



STEP 8 : Remember to finalize submission by saving changes

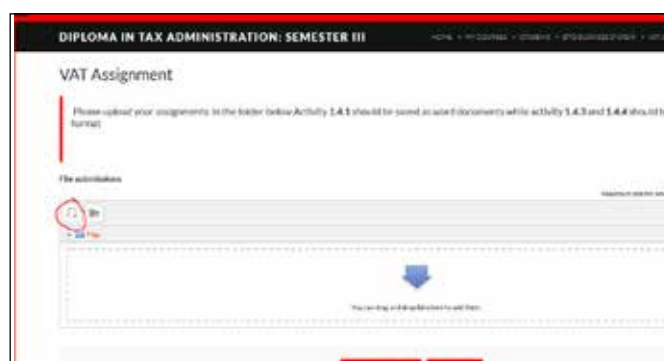
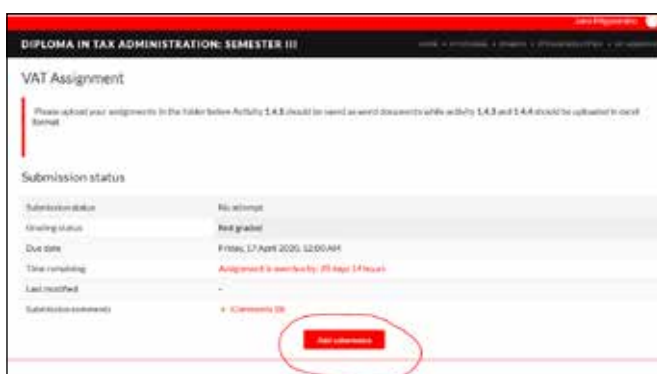

Reviewed Academic Fees Structure for eLearning

KESRA in response to the ongoing pandemic and to ensure that all students are accommodated and accessing quality services has reviewed the annual fees per programme.

The reviewed annual fees came into effect in June 2020 September and are as below;

Activity	EACFFPC	Certificate	Diploma	PGD	Masters
Semester I	21,000	28,000	40,000	55,000	70,000
Semester II	21,000	28,000	40,000	55,000	70,000
Semester III	N/A	28,000	32,000	55,000	70,000
Semester IV	N/A	N/A	N/A	N/A	70,000
Semester V	N/A	N/A	32,000	N/A	70,000
Total Fees	42,000	84,000	144,000	165,000	350,000



Kenya School of Revenue
Administration

Looking to build your expertise in Tax or Customs?

Acquire a Higher National Diploma in Tax or
Customs Administration through a flexible
modular arrangement.

MODULES CURRENTLY AVAILABLE:

Customs Administration:

1. Organization & Management of Customs Administration.
2. Customs Valuation 1

Tax Administration:

1. Income Tax 1
2. VAT Law & Practice

STUDY MODES: DAY OR EVENING

Apply today via kesra.ac.ke or Email: admissions@kra.go.ke

 Kenya School of Revenue Administration (KESRA)

 KESRA_KRA

 Kenya School of Revenue Administration (KESRA)

 schoolofrevenueadministration

KESRA hosts Customs experts in second Economic Dialogues webinar



KESRA ECONOMIC DIALOGUES
A thought leadership perspective on

The Status of Customs & Global Supply Chains: the context of the COVID-19 Pandemic

SPEAKER



Dr. Kunio Mikuriya,
Secretary General,
World Customs Organization (WCO)

SPEAKER



H.E Erastus Mwencha,
Former Deputy Chairperson of the African Union Commission (AU) and former Secretary General of the Common Market for Eastern and Southern Africa (COMESA)

MODERATOR



Dr. Fred Mugambi,
Commissioner/Head KESRA

International trade has been heavily impacted as the COVID-19 pandemic continues to cause unprecedented disruption of markets and the global supply chain. The pandemic, which started in China, continues to impede the growth of global economies.

To support businesses and individuals during this period, KESRA held its second session of Economic Dialogues, themed 'Customs and Global Supply Chains: the context of the COVID-19 Pandemic'.

The webinar, moderated by Head of KESRA Dr Fred Mugambi, brought together Customs experts, academia, policy makers and individuals from different parts of the world.

COVID-19 has presented a unique situation that requires businesses to quickly adapt to the 'new normal' in order to survive. For sustainability of the supply chain, technological development cannot be overemphasized. The World Bank forecasts a 5.2 per cent contraction in 2020 because of the pandemic.

Speaking during the webinar,

World Customs Organization (WCO) Secretary General Dr Kunio Mikuriya said that global trade continues to be disrupted as infections rise globally.

"While borders are closed for people and movement restricted, they are open to enable flow of medical and essential goods," said Dr Mikuriya.

Apart from facilitating trade, he said that WCO is reviewing its customs procedures to align them with the prevailing situation, with a focus on risk management and regular engagements with business communities to facilitate movement of goods. Dr Mikuriya further added that to strengthen international cooperation in trade, WCO provides technical assistance in implementation of its standards and procedures.

"By building a pool of experts in the area of Customs, we seek to strengthen regional cooperation in Africa to enable assistance provided to Africa by Africa," he added. Former Deputy Chairperson of the African Union (AU) Commission, HE Erastus Mwencha, said that regional

cooperation and trade among African countries supports collective growth. Mr Mwencha, who is also the former Secretary General of the Common Market for Eastern and Southern Africa (COMESA), noted that Africa's agricultural sector could go a long way in enhancing economic growth through production and export of food products.

In line with the annual theme, 'Customs fostering Sustainability for People, Prosperity and the Planet', Dr Mikuriya urged Customs officers globally to build and contribute to sustainability by facilitating trade to not only sustain the people, but also the world. He added that customs administrations have an opportunity to demonstrate resilience in the supply chain, enabled by technology and building trust with stakeholders.

KESRA's Economic Dialogues is a leadership forum aimed at sharing experiences and best practice to drive economic cooperation and growth in Africa. KESRA is one of the four WCO Regional Training Centres for the East and Southern



The world is increasingly going digital. This creates both opportunities and challenges, calling for changes to existing policies and adoption of new policies in many areas. Many countries are poorly prepared.

One striking way that digitalization is impacting on our economies is through growth in e-commerce. According to UNCTAD's latest estimates, global e-commerce sales in 2018 amounted to \$25.6 trillion, up 8% over 2017. A growing share of e-commerce involves cross-border sales and therefore contributes to international trade. For example, the share of the 1.45 billion online shoppers worldwide that made cross-border purchases rose from 17% in 2016 to 23% in 2018.

The value of e-commerce and contactless payments has been accentuated by the current COVID-19 crisis, provoking actions by governments. Much of this digital innovation is taking place in Africa. In Senegal, the Ministry of Trade and SMEs is partnering with the private sector to facilitate delivery of essential goods and services through e-commerce. In Uganda, the Ministry of ICT has made a call to develop digital solutions in the fight against COVID-19 to support health systems and public service delivery. Platforms have also been put in place linking informal operators to established marketplaces and helping out-of-reach households access market vendors, using local transport solutions. Central banks

and regulators, such as the Central Bank of West African States, have taken measures aimed at reducing transactions costs of electronic payments, boosting uptake of cashless e-government solutions, for example, for the provision of monetary transfers to the most vulnerable groups.

Digital solutions help reduce the spread of the virus by minimizing need for face to face interactions, and at the same time keeping some businesses from closing shop. And the digital world has served as welcome palliative amidst prolonged physical distancing and self-isolation during the crisis. This deepening in the digital shift has wide implications

Subscription Form: <https://forms.gle/ED5U4dgpFwbrhbbN6>

Opportunities & Resources



**AFRICAN TAX AND CUSTOMS
REVIEW (ATCR) JOURNAL**

Call for Papers

THEME: REVENUE ADMINISTRATION DURING THE PANDEMIC ERA

Submission of abstracts are welcome for the following thematic areas:

<ol style="list-style-type: none"> 1. Digitalization 2. Legal implications in Tax and Custom 3. Tax or/and Customs Reform Policies 4. Alternative Dispute Resolution 5. Risk Management 	<ol style="list-style-type: none"> 6. Business Continuity Management 7. Tax or/and Customs Compliance 8. Governance and Leadership 9. Enforcement 10. Illicit Trade
--	--

IMPORTANT DATES: 

1. Submission of Abstracts by **30th October 2020**
2. Submission of completed Research paper by **31st March 2021**
3. Review and Editing of Research papers by **April 2021**
4. Publication to the African Tax & Customs Review (ATCR) Journal by **May 2021**



Any opinion, article or research paper to be sent to:
 Email: submissions.atcr@kra.go.ke
<https://10.10.110.177/ojs>
<https://atcr.kra.go.ke/ojs>

Every year various organization place a call for research papers. This is an exciting opportunity for learners to submit articles for review and publication. You are encouraged to look out for these opportunities to grow your brand and enhance your visibility i.e. KESRA Research Conference, WCO Picard Conference, WTO through the Economic Research and Statistics Division, TNC Journal by UNCTAD amongst others.

Access to e-library

You can now access the e-library resource remotely on the link below:

<https://kraresources.remotexs.co/>

Tax Prism Issue 4

Tax prism Issue No. 004 thematic area of focus :
Fiscal and monetary matters

Available October-December 2020

Internship Opportunities

Government institutions provide internship opportunities every year. The objective is to developing a pool of young talented workforce for the Kenyan labor market. Look out for these opportunities and gain hands-on work experience and employability skills.

For feedback (compliments/complaint) or more information contact us on : kesrafeedback@kra.go.ke



Kenya School of Revenue Administration (KESRA)



Kenya School of Revenue Administration



@KESRA_KRA